

## NPN Silicon RF Transistor

- For high gain low noise amplifiers
- For oscillators up to 10 GHz
- Noise figure  $F = 1.1$  dB at 1.8 GHz  
outstanding  $G_{ms} = 21$  dB at 1.8 GHz
- Transition frequency  $f_T = 25$  GHz
- Gold metallization for high reliability
- SIEGET<sup>®</sup> 25 GHz  $f_T$  - Line
- Pb-free (RoHS compliant) package<sup>1)</sup>
- Qualified according AEC Q101

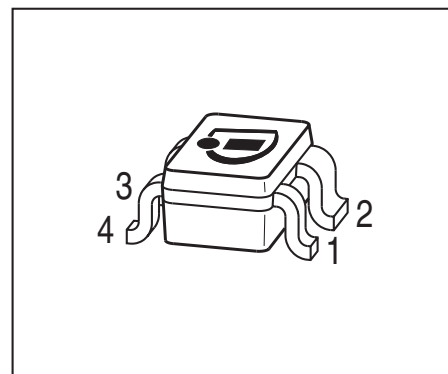

**ESD (Electrostatic discharge) sensitive device, observe handling precaution!**

| Type   | Marking | Pin Configuration |     |     |     |   |   | Package |
|--------|---------|-------------------|-----|-----|-----|---|---|---------|
| BFP420 | AMs     | 1=B               | 2=E | 3=C | 4=E | - | - | SOT343  |

### Maximum Ratings

| Parameter                                                    | Symbol    | Value       | Unit |
|--------------------------------------------------------------|-----------|-------------|------|
| Collector-emitter voltage<br>$T_A > 0$ °C<br>$T_A \leq 0$ °C | $V_{CEO}$ | 4.5<br>4.1  | V    |
| Collector-emitter voltage                                    | $V_{CES}$ | 15          |      |
| Collector-base voltage                                       | $V_{CBO}$ | 15          |      |
| Emitter-base voltage                                         | $V_{EBO}$ | 1.5         |      |
| Collector current                                            | $I_C$     | 35          | mA   |
| Base current                                                 | $I_B$     | 3           |      |
| Total power dissipation <sup>2)</sup><br>$T_S \leq 107$ °C   | $P_{tot}$ | 160         | mW   |
| Junction temperature                                         | $T_j$     | 150         | °C   |
| Ambient temperature                                          | $T_A$     | -65 ... 150 |      |
| Storage temperature                                          | $T_{stg}$ | -65 ... 150 |      |

<sup>1)</sup>Pb-containing package may be available upon special request

<sup>2)</sup> $T_S$  is measured on the collector lead at the soldering point to the pcb

**Thermal Resistance**

| Parameter                                | Symbol     | Value      | Unit |
|------------------------------------------|------------|------------|------|
| Junction - soldering point <sup>1)</sup> | $R_{thJS}$ | $\leq 260$ | K/W  |

**Electrical Characteristics** at  $T_A = 25^\circ\text{C}$ , unless otherwise specified

| Parameter | Symbol | Values |      |      | Unit |
|-----------|--------|--------|------|------|------|
|           |        | min.   | typ. | max. |      |

**DC Characteristics**

|                                                                               |               |     |    |     |               |
|-------------------------------------------------------------------------------|---------------|-----|----|-----|---------------|
| Collector-emitter breakdown voltage<br>$I_C = 1\text{ mA}, I_B = 0$           | $V_{(BR)CEO}$ | 4.5 | 5  | -   | V             |
| Collector-emitter cutoff current<br>$V_{CE} = 15\text{ V}, V_{BE} = 0$        | $I_{CES}$     | -   | -  | 10  | $\mu\text{A}$ |
| Collector-base cutoff current<br>$V_{CB} = 5\text{ V}, I_E = 0$               | $I_{CBO}$     | -   | -  | 100 | nA            |
| Emitter-base cutoff current<br>$V_{EB} = 0.5\text{ V}, I_C = 0$               | $I_{EBO}$     | -   | -  | 3   | $\mu\text{A}$ |
| DC current gain<br>$I_C = 20\text{ mA}, V_{CE} = 4\text{ V}$ , pulse measured | $h_{FE}$      | 60  | 95 | 130 | -             |

<sup>1)</sup>For calculation of  $R_{thJA}$  please refer to Application Note Thermal Resistance

**Electrical Characteristics at  $T_A = 25^\circ\text{C}$ , unless otherwise specified**

| Parameter                                                                                                                                                | Symbol       | Values |      |      | Unit |
|----------------------------------------------------------------------------------------------------------------------------------------------------------|--------------|--------|------|------|------|
|                                                                                                                                                          |              | min.   | typ. | max. |      |
| <b>AC Characteristics</b> (verified by random sampling)                                                                                                  |              |        |      |      |      |
| Transition frequency<br>$I_C = 30\text{ mA}$ , $V_{CE} = 3\text{ V}$ , $f = 2\text{ GHz}$                                                                | $f_T$        | 18     | 25   | -    | GHz  |
| Collector-base capacitance<br>$V_{CB} = 2\text{ V}$ , $f = 1\text{ MHz}$ , $V_{BE} = 0$ ,<br>emitter grounded                                            | $C_{cb}$     | -      | 0.15 | 0.3  | pF   |
| Collector emitter capacitance<br>$V_{CE} = 2\text{ V}$ , $f = 1\text{ MHz}$ , $V_{BE} = 0$ ,<br>base grounded                                            | $C_{ce}$     | -      | 0.37 | -    |      |
| Emitter-base capacitance<br>$V_{EB} = 0.5\text{ V}$ , $f = 1\text{ MHz}$ , $V_{CB} = 0$ ,<br>collector grounded                                          | $C_{eb}$     | -      | 0.55 | -    |      |
| Noise figure<br>$I_C = 5\text{ mA}$ , $V_{CE} = 2\text{ V}$ , $f = 1.8\text{ GHz}$ , $Z_S = Z_{Sopt}$                                                    | $F$          | -      | 1.1  | -    | dB   |
| Power gain, maximum stable <sup>1)</sup><br>$I_C = 20\text{ mA}$ , $V_{CE} = 2\text{ V}$ , $Z_S = Z_{Sopt}$ ,<br>$Z_L = Z_{Lopt}$ , $f = 1.8\text{ GHz}$ | $G_{ms}$     | -      | 21   | -    | dB   |
| Insertion power gain<br>$V_{CE} = 2\text{ V}$ , $I_C = 20\text{ mA}$ , $f = 1.8\text{ GHz}$ ,<br>$Z_S = Z_L = 50\ \Omega$                                | $ S_{21} ^2$ | 14     | 17   | -    |      |
| Third order intercept point at output <sup>2)</sup><br>$V_{CE} = 2\text{ V}$ , $I_C = 20\text{ mA}$ , $f = 1.8\text{ GHz}$ ,<br>$Z_S = Z_L = 50\ \Omega$ | $IP_3$       | -      | 22   | -    | dBm  |
| 1dB Compression point at output<br>$I_C = 20\text{ mA}$ , $V_{CE} = 2\text{ V}$ , $Z_S = Z_L = 50\ \Omega$ ,<br>$f = 1.8\text{ GHz}$                     | $P_{-1dB}$   | -      | 12   | -    |      |

<sup>1)</sup>  $G_{ms} = |S_{21}| / |S_{12}|$ 
<sup>2)</sup>  $IP_3$  value depends on termination of all intermodulation frequency components.  
Termination used for this measurement is  $50\ \Omega$  from 0.1 MHz to 6 GHz

**Simulation Data**

For SPICE-model as well as for S-parameters including noise parameters refer to our internet website: [www.infineon.com/rf.models](http://www.infineon.com/rf.models). Please consult our website and download the latest version before actually starting your design.

The simulation data have been generated and verified up to 10 GHz using typical devices. The BFP420 nonlinear SPICE-model reflects the typical DC- and RF-device performance with high accuracy.

**Total power dissipation**  $P_{\text{tot}} = f(T_S)$

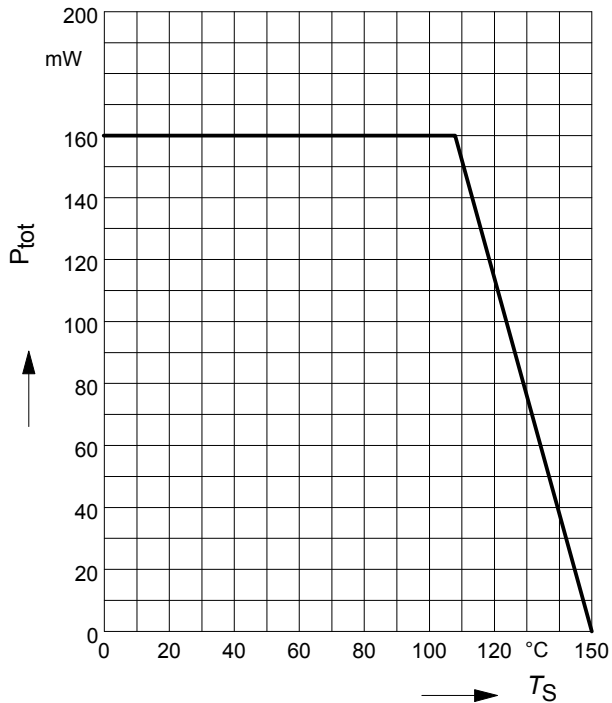

**Permissible Pulse Load**  $R_{\text{thJS}} = f(t_p)$

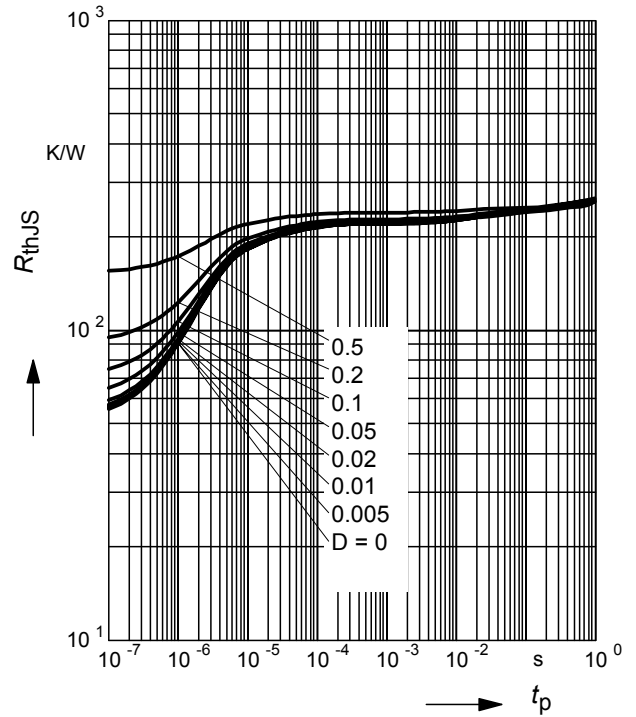

**Permissible Pulse Load**

$P_{\text{totmax}}/P_{\text{totDC}} = f(t_p)$

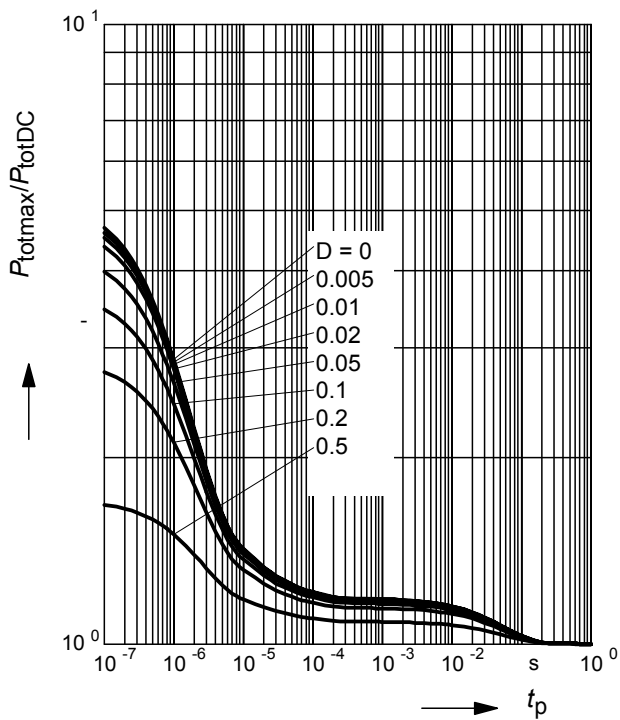

**Collector-base capacitance**  $C_{\text{cb}} = f(V_{\text{CB}})$

$f = 1\text{MHz}$

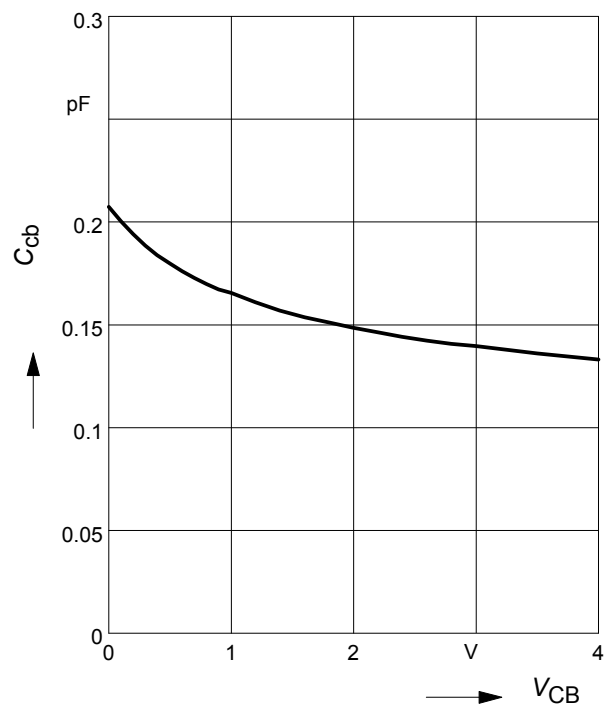

**Transition frequency  $f_T = f(I_C)$**

$f = 2 \text{ GHz}$

$V_{CE} = \text{parameter in V}$

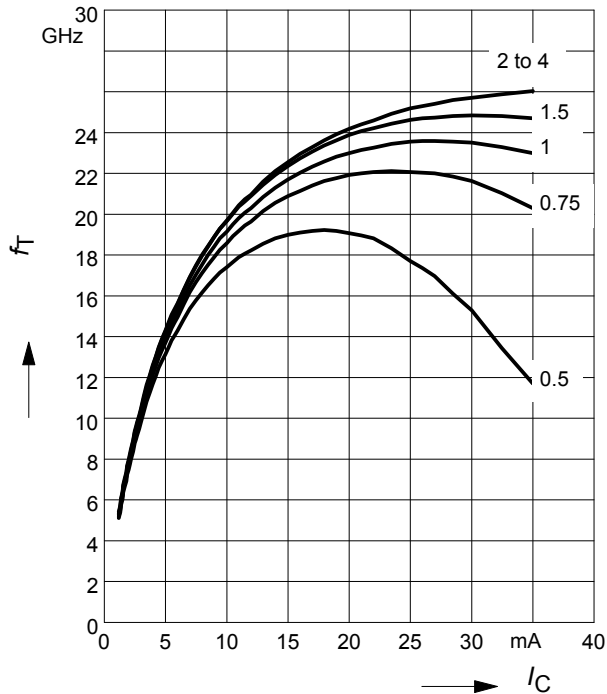

**Power gain  $G_{ma}, G_{ms}, |S_{21}|^2 = f(f)$**

$V_{CE} = 2 \text{ V}, I_C = 20 \text{ mA}$

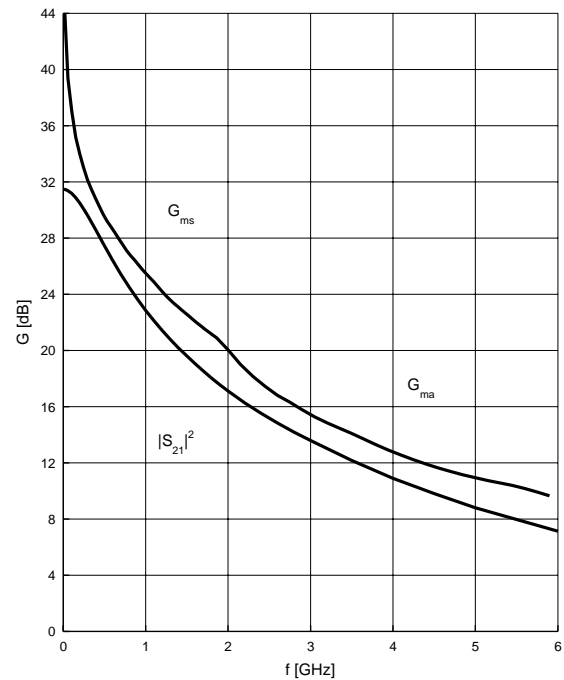

**Power gain  $G_{ma}, G_{ms} = f(I_C)$**

$V_{CE} = 2 \text{ V}$

$f = \text{parameter in GHz}$

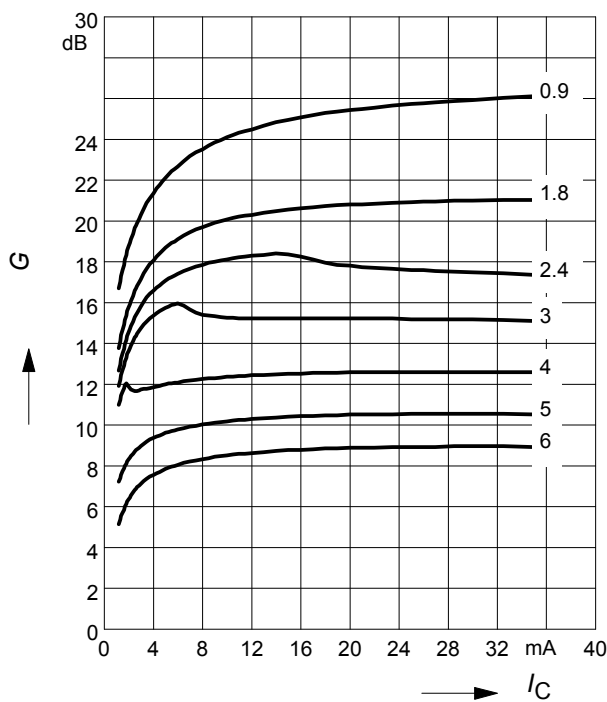

**Power gain  $G_{ma}, G_{ms} = f(V_{CE})$**

$I_C = 20 \text{ mA}$

$f = \text{parameter in GHz}$

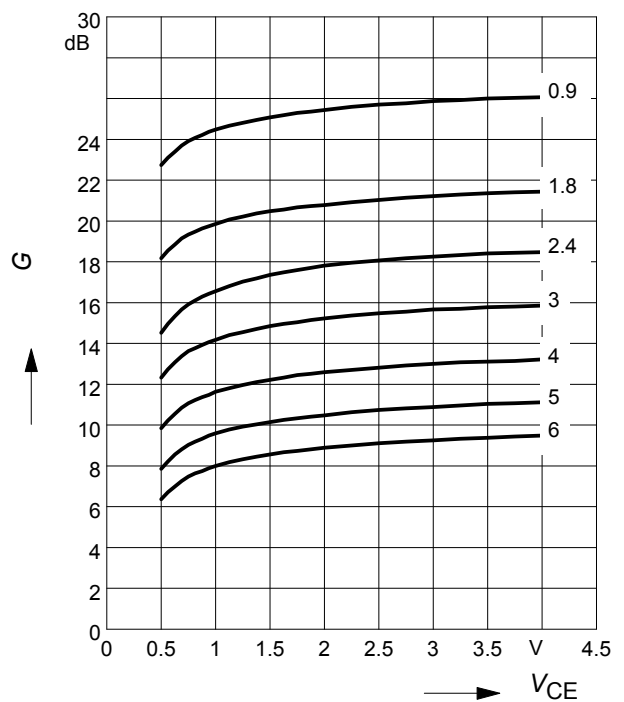

**Noise figure  $F = f(I_C)$**

$V_{CE} = 2\text{ V}$ ,  $Z_S = Z_{Sopt}$

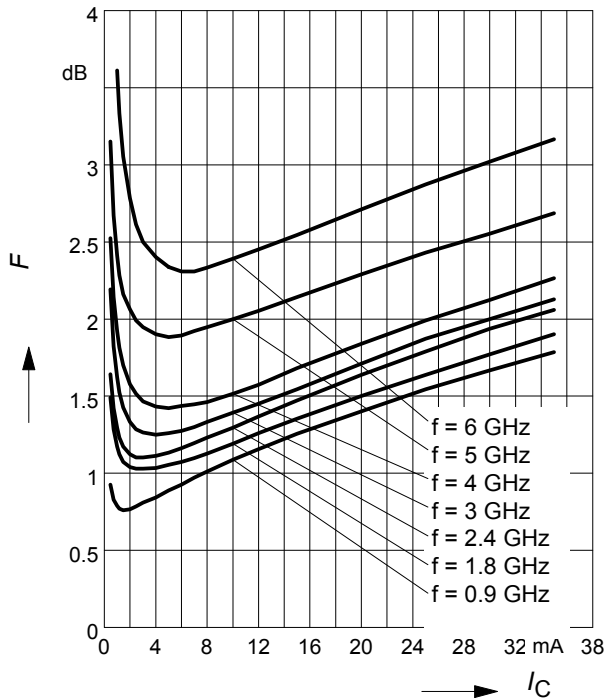

**Noise figure  $F = f(I_C)$**

$V_{CE} = 2\text{ V}$ ,  $f = 1.8\text{ GHz}$

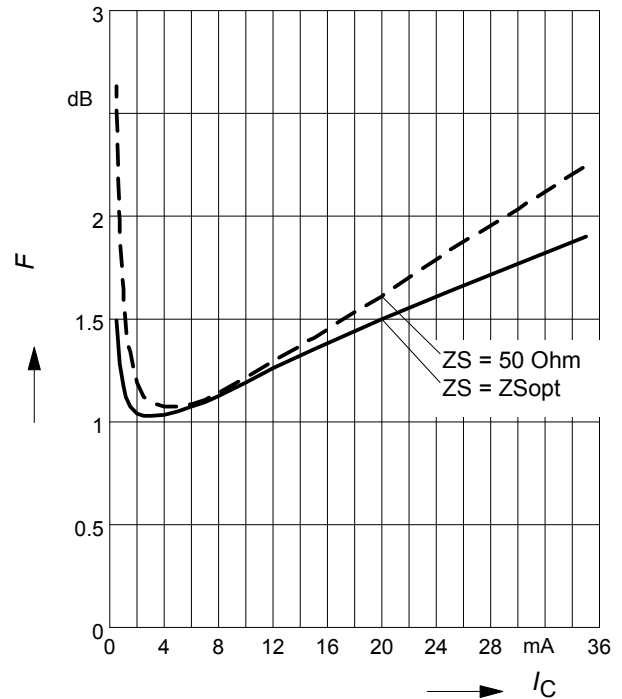

**Noise figure  $F = f(f)$**

$V_{CE} = 2\text{ V}$ ,  $Z_S = Z_{Sopt}$

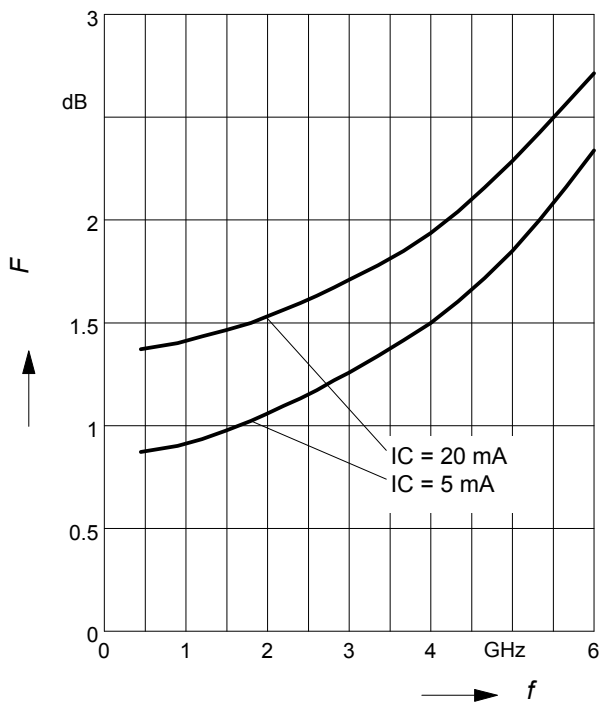

**Source impedance for min.**

noise figure vs. frequency

$V_{CE} = 2\text{ V}$ ,  $I_C = 5\text{ mA} / 20\text{ mA}$

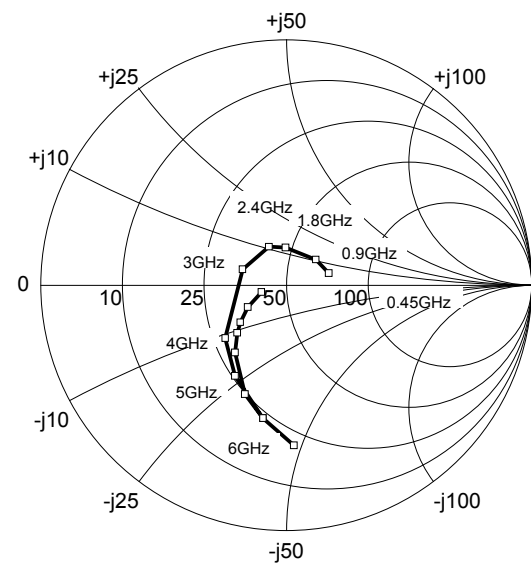

## Package Outline

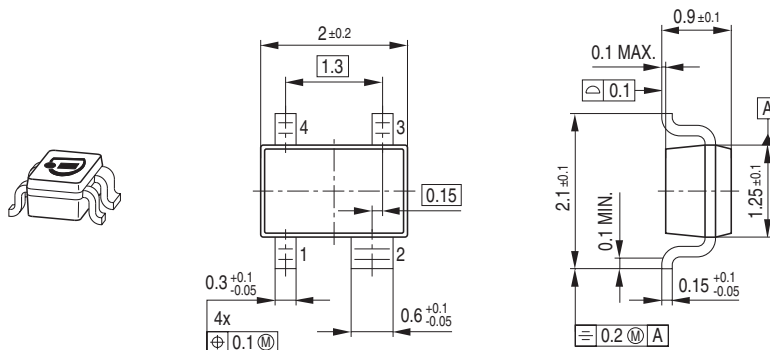

## Foot Print

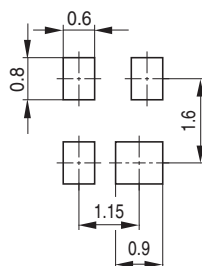

## Marking Layout (Example)

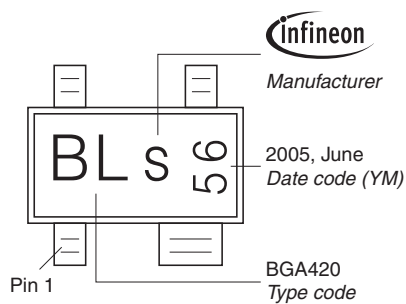

## Standard Packing

Reel ø180 mm = 3.000 Pieces/Reel  
Reel ø330 mm = 10.000 Pieces/Reel

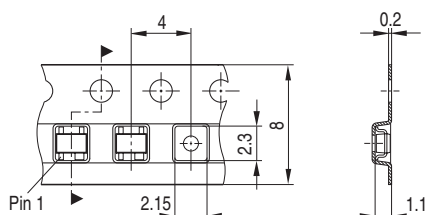



Edition 2009-12-02

Published by

Infineon Technologies AG

85579 Neubiberg, Germany

© Infineon Technologies AG 2009.

All Rights Reserved.

### **Attention please!**

The information herein is given to describe certain components and shall not be considered as a guarantee of characteristics.

Terms of delivery and rights to technical change reserved.

We hereby disclaim any and all warranties, including but not limited to warranties of non-infringement, regarding circuits, descriptions and charts stated herein.

### **Information**

For further information on technology, delivery terms and conditions and prices please contact your nearest Infineon Technologies Office ([www.infineon.com](http://www.infineon.com)).

### **Warnings**

Due to technical requirements components may contain dangerous substances.

For information on the types in question please contact your nearest Infineon Technologies Office.

Infineon Technologies Components may only be used in life-support devices or systems with the express written approval of Infineon Technologies, if a failure of such components can reasonably be expected to cause the failure of that life-support device or system, or to affect the safety or effectiveness of that device or system.

Life support devices or systems are intended to be implanted in the human body, or to support and/or maintain and sustain and/or protect human life. If they fail, it is reasonable to assume that the health of the user or other persons may be endangered.